

SETTLEMENT
AGREEMENT
EXHIBIT B

For Path of Travel Continuation
See Exhibit J

For Path of Travel Continuation
See Exhibit J

For Path of Travel Continuation
See Exhibit J

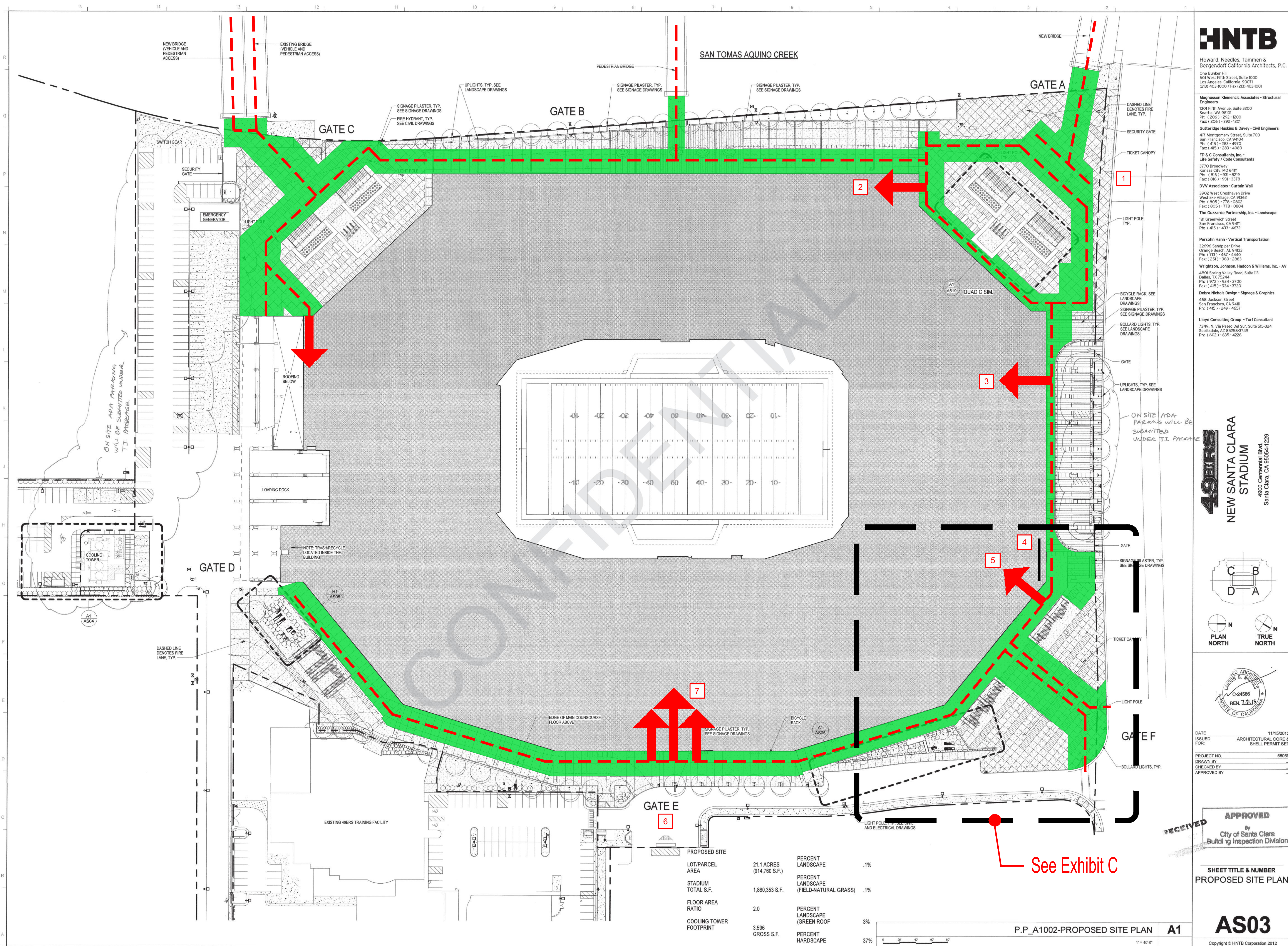

- 1 STADIUM ENTRY GATE A - ACCESSIBLE ROUTE FULL LENGTH X 8 FOOT WIDE EACH SIDE
- 2 ACCESS TO ELEVATOR B1 & LEVEL 300 ACCESSIBLE SEATING, LEVEL 400 CLUB & ACCESSIBLE SEATING
- 3 ENTRY DOOR TO 49ERS MUSEUM & ELEVATORS B5 & B6 WITH ACCESS TO LEVEL 300 ACCESSIBLE SEATING, LEVEL 500 SUITES, LEVEL 700 ACCESSIBLE SEATING
- 4 BOX OFFICE WINDOWS
- 5 TO ELEVATORS A4 & A5 ACCESS TO FIELD LEVEL ACCESSIBLE SEATING, 300 LEVEL ACCESSIBLE SEATING, 500 LEVEL SUITES & 700 LEVEL ACCESSIBLE SEATING
- 6 ENTRY DOORS TO ELEVATORS A6 & A7 ACCESS TO 300 LEVEL ACCESSIBLE SEATING, ACCESS TO 400 LEVEL CLUB
- 7 ENTRY DOOR WITH ACCESS TO FIELD LEVEL SEATING & ELEVATORS A1, A2 & A3 WITH ACCESS TO ADMINISTRATIVE OFFICES, 400 LEVEL CLUB, 500 LEVEL SUITES

- ENTRY DOOR TO ELEVATORS
- ACCESSIBLE ROUTE OF TRAVEL
- ACCESSIBLE ROUTE - 8 FOOT WIDE MINIMUM

THE COMPLETED ACCESS BARRIER REMOVAL WORK SHALL COMPLY WITH THE 2010 AMERICANS WITH DISABILITIES ACT STANDARDS AND THE CALIFORNIA BUILDING CODE IN EFFECT AT THE TIME OF THE WORK.

HNTB

Howard, Needles, Tammen & Bergendoff California Architects, P.C.
One Bunker Hill
601 West Fifth Street, Suite 2000
Los Angeles, California 90071
(213) 403-1000 / Fax (213) 403-1001

Magnuson Clemens Associates - Structural Engineers
1301 Fifth Avenue, Suite 3200
Seattle, WA 98101
Ph: (206) 392-1200
Fax: (206) 392-1205

Cutteridge Mackin & Dwyer - Civil Engineers
417 Montgomery Street, Suite 700
San Francisco, CA 94104
Ph: (415) 283-4970
Fax: (415) 283-4970

FP & C Consultants, Inc. - Life Safety / Code Consultants
3770 Broadway
Kansas City, MO 64111
Ph: (816) 931-8279
Fax: (816) 931-3378

DW Associates - Curtain Wall
3902 West Cresthaven Drive
Westlake Village, CA 91362
Ph: (805) 778-1954
Fax: (805) 778-1954

The Guzzardi Partnership, Inc. - Landscape
181 Greenwich Street
San Francisco, CA 94102
Ph: (415) 433-4672

Persohn Hahn - Vertical Transportation
32696 Sandpiper Drive
Orange Beach, AL 36633
Ph: (713) 467-4460
Fax: (251) 980-1883

Wrightson, Johnson, Haddon & Williams, Inc. - AV
4502 Spring Valley Road, Suite 103
Dallas, TX 75244
Ph: (415) 934-2720
Fax: (415) 934-2720

Debra Nichols Design - Signage & Graphics
458 Jackson Street
San Francisco, CA 94111
Ph: (415) 366-4657

Llyst Consulting Group - Turf Consultant
7349 N. Via Pineda Del Sur, Suite 555-324
Scottsdale, AZ 85258-3749
Ph: (602) 431-4228

49ERS
NEW SANTA CLARA
STADIUM
4900 Centennial Blvd.
Santa Clara, CA 95054-1229

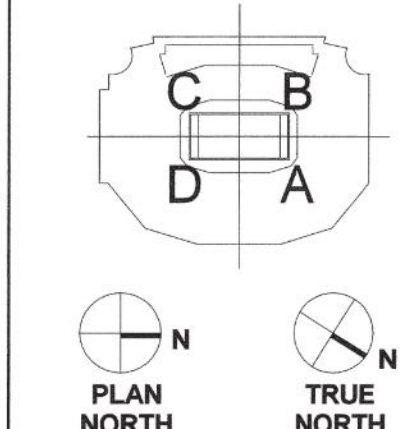

DATE ISSUED 11/15/2012
FOR ARCHITECTURAL CORE & SHELL PERMIT SET
PROJECT NO. 58099
DRAWN BY
CHECKED BY
APPROVED BY

APPROVED
By
City of Santa Clara
Building Inspection Division

SHEET TITLE & NUMBER
PROPOSED SITE PLAN

AS03

Copyright © HNTB Corporation 2012

Scale: NTS

Pacific Access Consulting
&
Gary Waters Architect

1421 Guerneville Road, Suite 230, Santa Rosa, CA 95403
Tel: 707/523-0849 Cell: 707/479-3872
Email: Gary@pam-architects.com

Seal:

Revisions:

| MARK | DATE | REVISION |
|------|----------|-------------------|
| △ | 09/14/19 | ISSUED FOR REVIEW |

Project:

LEVI STADIUM
ACCESSIBILITY

4900 Centennial Blvd.
Santa Clara, CA

Sheet Description:

SITE PLAN
GATES A, B, C, E, & F

Job No.: 19-008 Scale: AS SHOWN

Dwg File Name: Exhibit-B.dwg

Sheet:

EXHIBIT

B